

NOTES: UNLESS OTHERWISE NOTED

1. MACHINED SURFACE ROUGHNESS 64
O-RING GROOVES AND SURFACES 32
2. REMOVE ALL BURRS/SHARP CORNERS

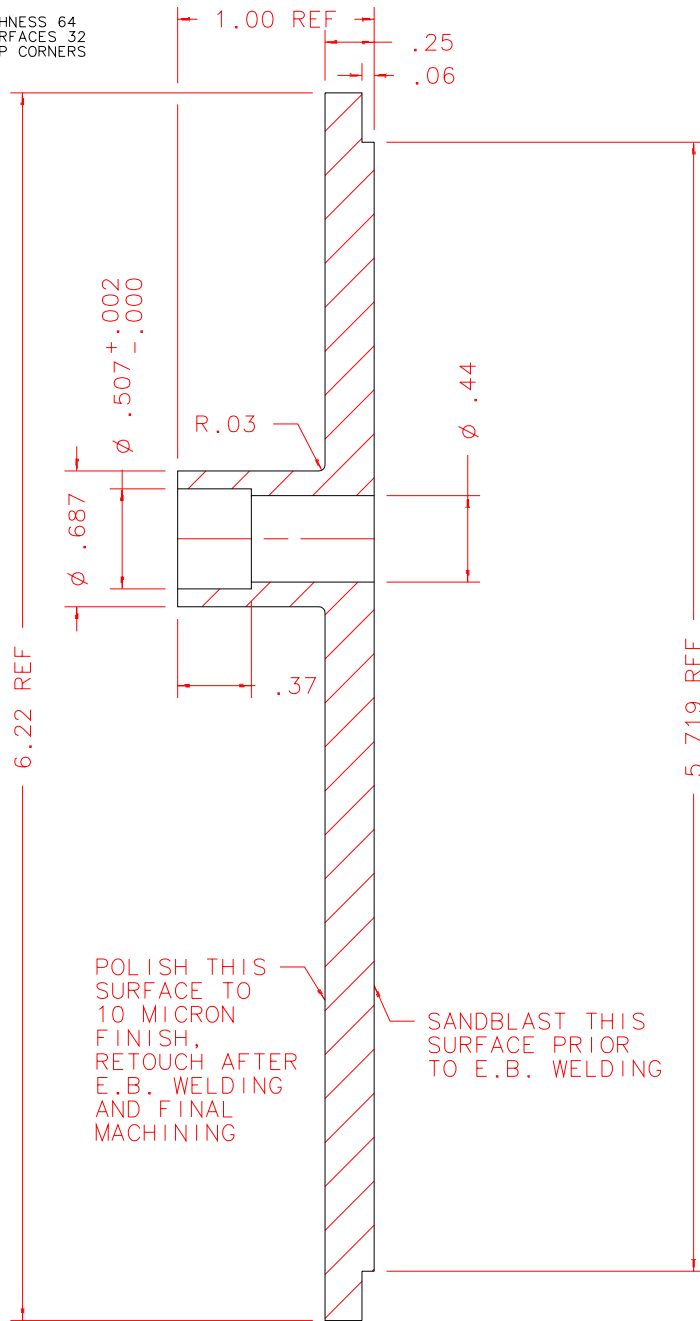

POLISH THIS SURFACE TO 10 MICRON FINISH, RETOUCH AFTER E.B. WELDING AND FINAL MACHINING

SANDBLAST THIS SURFACE PRIOR TO E.B. WELDING

SECTION A-A SCALE 1:1

PLOT: 10/19/99

BILL OF MATERIAL				
NO.	REQ'D	REF DRW	DESCRIPTION	MATERIAL
N/A	1	SL0-014A	ENDCAP -Z	ALU 2219

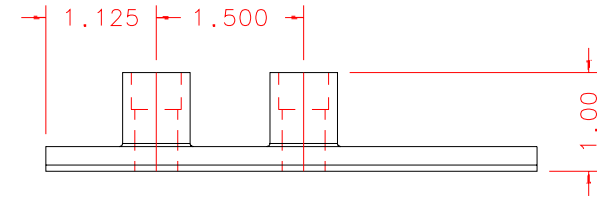

TOP

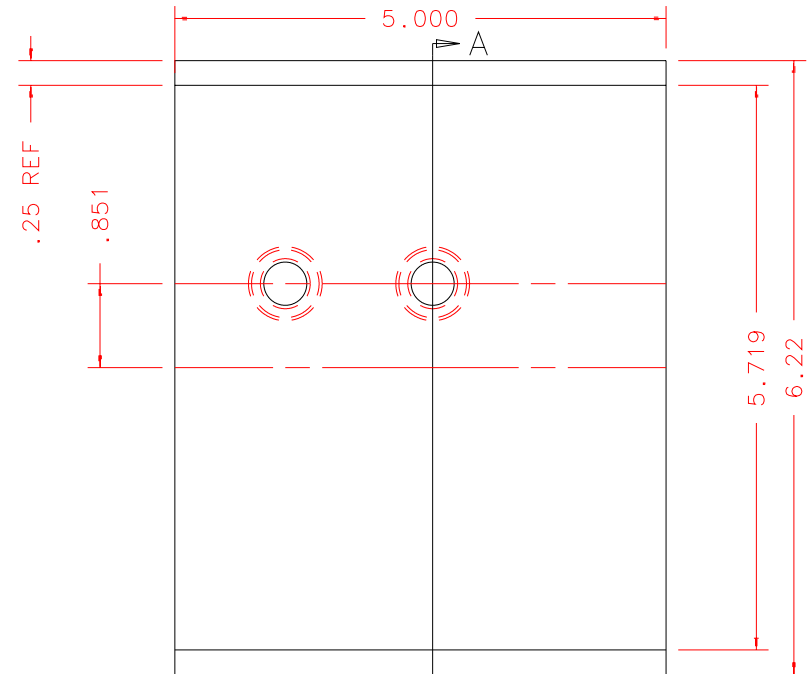

FRONT

REVDATE: N/A	REVISION: N/A
DATE: 03/25/97	INSTITUTE FOR ASTRONOMY
DESIGN: STAHLBERGER	2680 WOODLAWN DR. HONOLULU, HI 96822
DRAWN: STAHLBERGER	INSTRUMENT: SPEX - CROSS DISPERSED SPECTROGRAPH
APPR'D: J. RAYNER	PART NAME: ENDCAP -Z
TOLERANCES	
X.X	+/- .015
X.XX	+/- .005
X.XXX	+/- .002
ANGLE	+/- 30 min
FRACTION	+/- 1/32
TELESCOPE: IRTF	
DRW NO: SL0-014A	SCALE: 1:2
SIZE: A	JOS NO: 725
SHEET: 1 OF 1	

SL0-001B
NEXT ASSY