

NOTES: UNLESS OTHERWISE NOTED

1. MACHINED SURFACE ROUGHNESS 64
O-RING GROOVES AND SURFACES 32
2. REMOVE ALL BURRS/SHARP CORNERS

NOTES:

- 1) ALL DIAMETERS CONCENTRIC TO .0005 TIR
- 2) DIMENSIONS WITH ASTERISK: MEASURE KAYDON BEARING, MAKE LIGHT PRESS OF .0002 2 PLCS

BILL OF MATERIAL				
NO.	REQ'D	REF DRW	DESCRIPTION	MATERIAL
N/A	1	SF1-012A	BEARING SHAFT	ALU 6061-T6

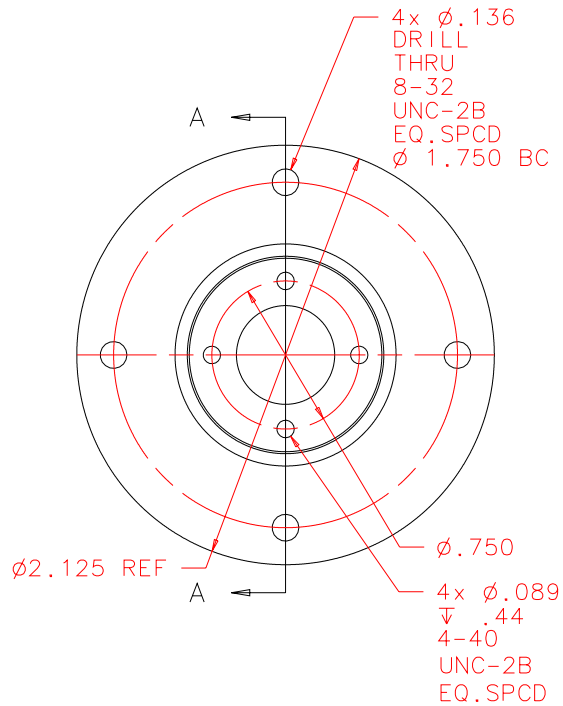

FRONT

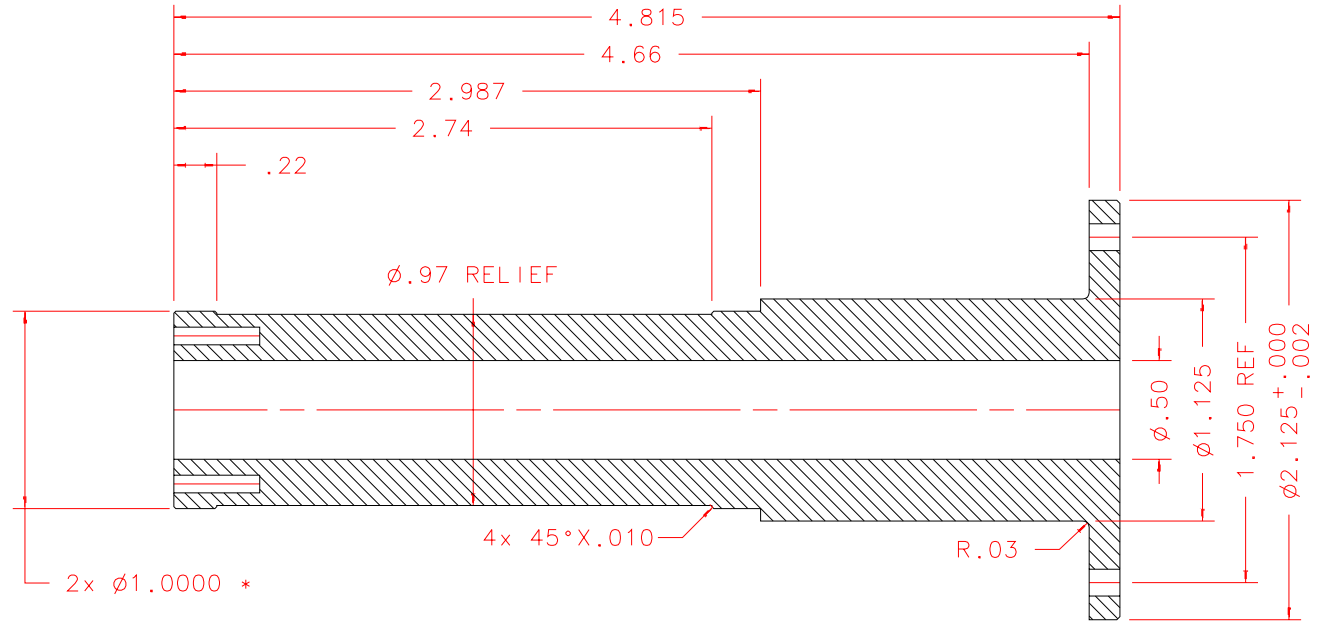

SECTION A-A

REVDATE: N/A	REVISION: N/A
DATE: 01/06/99	INSTITUTE FOR ASTRONOMY
DESIGN: STAHLBERGER	2680 WOODLAWN DR. HONOLULU, HI 96822
DRAWN: STAHLBERGER	INSTRUMENT: SPEX - CROSS DISPERSED SPECTROGRAPH
APPR'D: J. RAYNER	PART NAME: BEARING SHAFT
TOLERANCES	
X.X	+/- .015
X.XX	+/- .005
X.XXX	+/- .002
ANGLE	+/- 30 min
FRACTION	+/- 1/32
DRW NO: SF1-012A	SCALE: 1:1
SIZE: A	JOS NO: 725
SHEET: 1 OF 1	

PLOT:10/19/99

SF1-001A
NEXT ASSY