

NOTES: UNLESS OTHERWISE NOTED

1. MACHINED SURFACE ROUGHNESS 64  
O-RING GROOVES AND SURFACES 32
2. REMOVE ALL BURRS/SHARP CORNERS

MAKE ONE EACH  
W/FOLLOWING  
THICKNESS:  
.010 INCH  
.015 INCH  
.020 INCH  
.025 INCH  
SUBSTITUTE  
WITH TITANIUM  
AS NEEDED

BILL OF MATERIAL				
NO.	REQ'D	REF DRW	DESCRIPTION	MATERIAL
N/A	N/A	SK5-017A	SXD1 RADIAL SPRING	PHOS.BRONZE

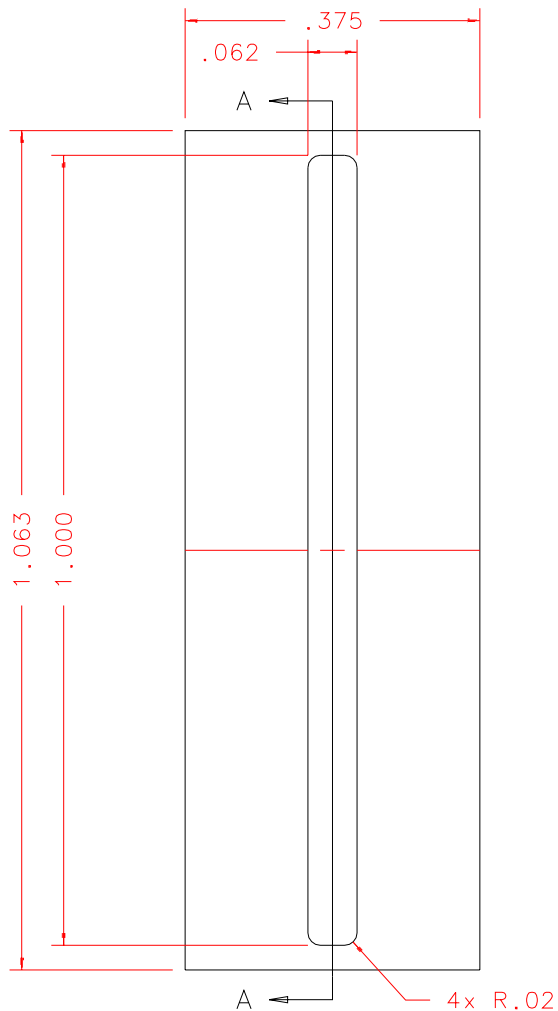

FRONT

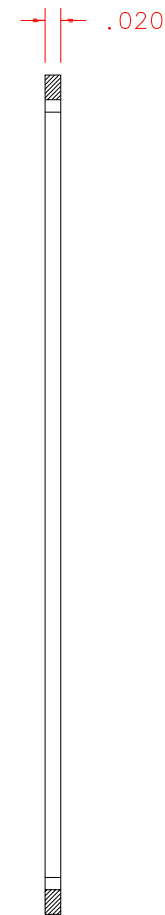

SECTION A-A

REVDATE: N/A	REVISION: N/A
DATE: 06/29/99	<b>INSTITUTE FOR ASTRONOMY</b>
DESIGN: STAHLBERGER	2680 WOODLAWN DR. HONOLULU, HI 96822
DRAWN: STAHLBERGER	INSTRUMENT: SPEX - CROSS DISPERSED SPECTROGRAPH
APPR'D: J. RAYNER	PART NAME: SXD1 RADIAL SPRING
<b>TOLERANCES</b>	
X.X	+/- .015
X.XX	+/- .005
X.XXX	+/- .002
ANGLE	+/- 30 min
FRACTION	+/- 1/32
DRW NO: SK5-017A	SCALE: 4:1
SIZE: A	JOS NO: 725
SHEET: 1 OF 1	

SK5-001B
NEXT ASSY

PLOT:10/19/99