

NOTES: UNLESS OTHERWISE NOTED
 1. MACHINED SURFACE ROUGHNESS 64
 O-RING GROOVES AND SURFACES 32
 2. REMOVE ALL BURRS/SHARP CORNERS

BILL OF MATERIAL				
NO.	REQ'D	REF DRW	DESCRIPTION	MATERIAL
N/A	1	SK5-023B	SXD1 PRISM MOUNT VER2	ALU 6061-T6

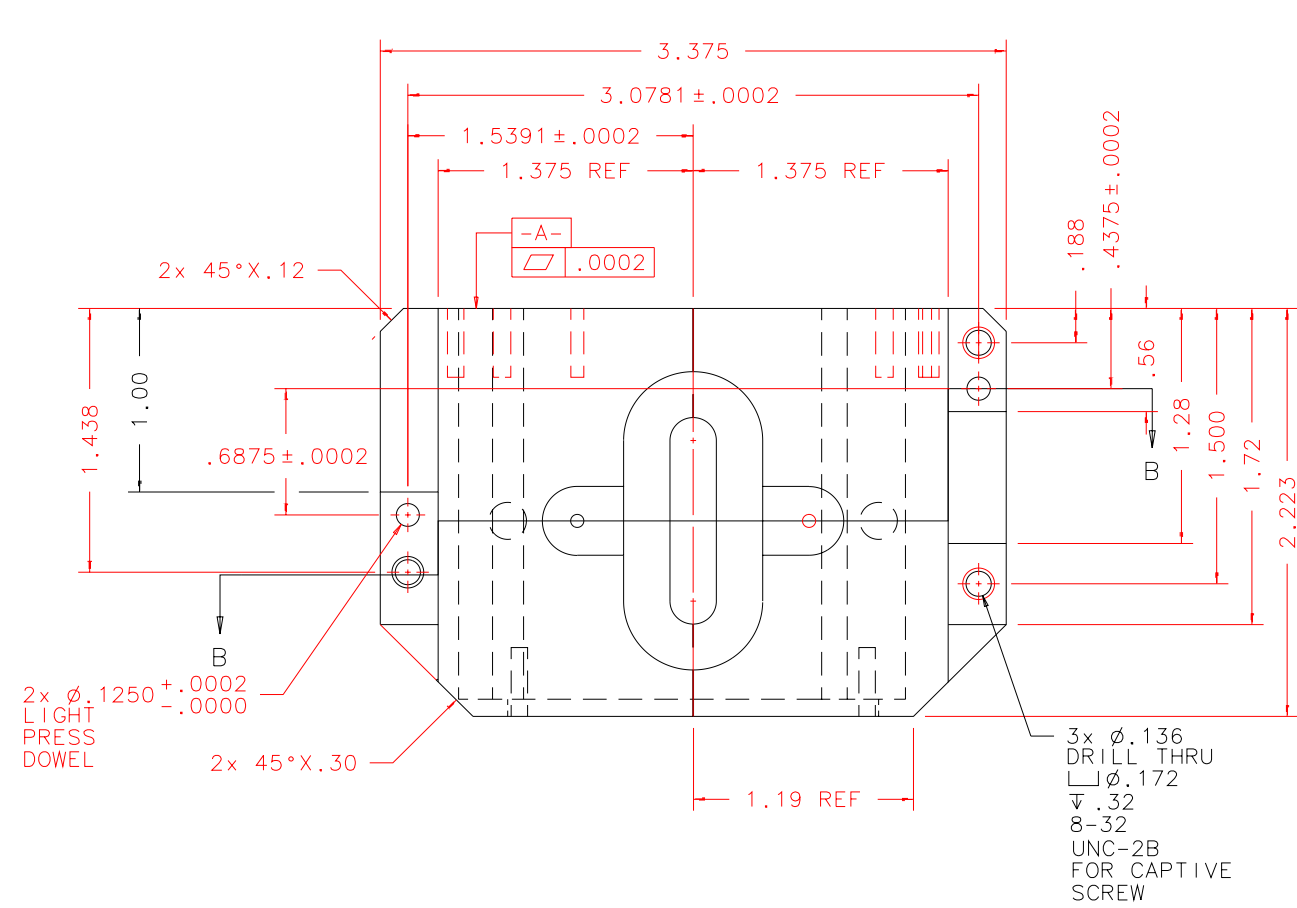

BOTTOM

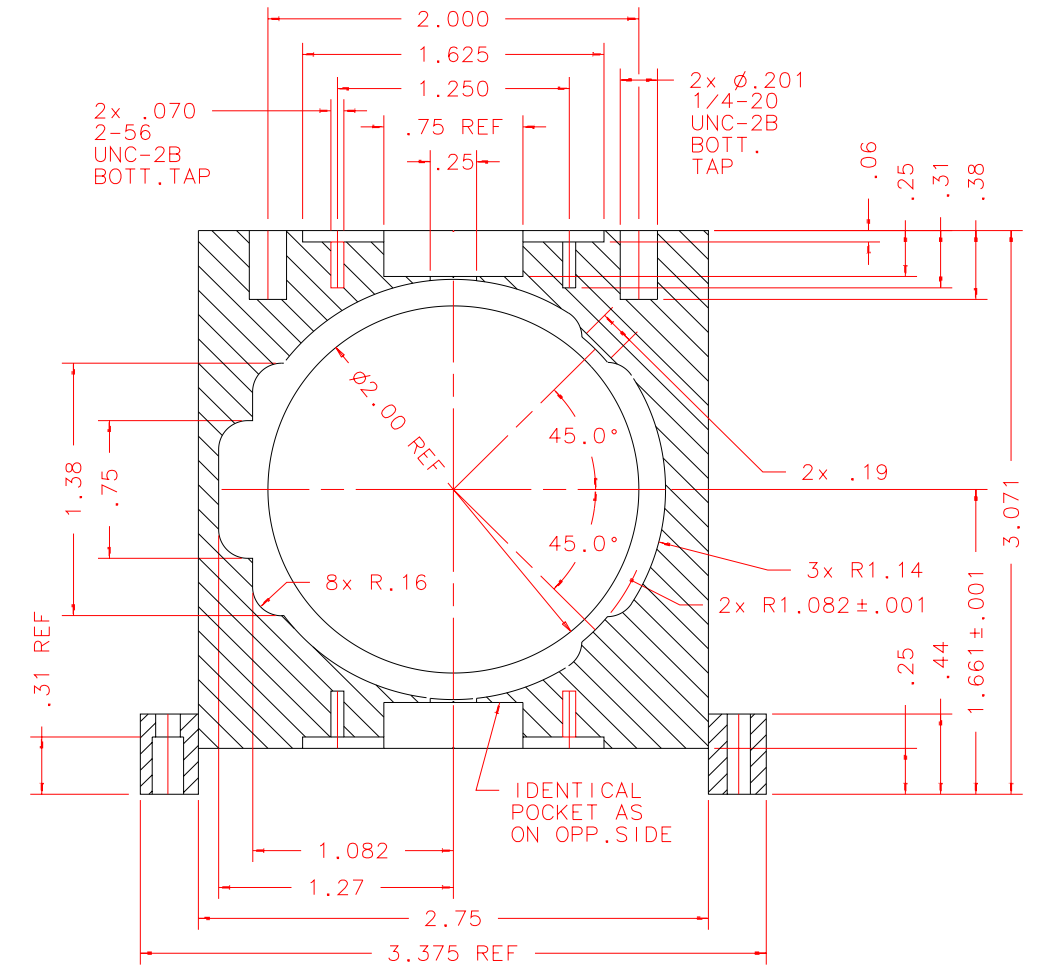

SECTION B-B

REVDATE: 08/16/99	REVISION: ADD SECOND FIDUCIAL PORT
REVDATE: 08/10/99	REVISION: ADD CAPTIVE SCREW DETAIL
REVDATE: 08/10/99	REVISION: DIM 4 TAPPED HOLES
REVDATE: N/A	REVISION: N/A
DATE: 06/28/99	INSTITUTE FOR ASTRONOMY
DESIGN: STAHLBERGER	2680 WOODLAWN DR. HONOLULU, HI 96822
DRAWN: STAHLBERGER	INSTRUMENT: SPEX - CROSS DISPERSED SPECTROGRAPH
APPR'D: J. RAYNER	PART NAME: SXD1 PRISM MOUNT VER2
	TELESCOPE: IRTF
TOLERANCES	
X.X	+/- .015
X.XX	+/- .005
X.XXX	+/- .002
ANGLE	+/- 30 min
FRACTION	+/- 1/32
SK5-001B	DRW NO: SK5-023B
NEXT ASSY	SCALE: 1:1
	SIZE: B
	JOS NO: 725
	SHEET: 2 OF 3

PLOT: 10/19/99