

NOTES: UNLESS OTHERWISE NOTED
 1. MACHINED SURFACE ROUGHNESS 64
 O-RING GROOVES AND SURFACES 32
 2. REMOVE ALL BURRS/SHARP CORNERS

| BILL OF MATERIAL | | | | |
|------------------|-------|----------|----------------------------------|-------------|
| NO. | REQ'D | REF DRW | DESCRIPTION | MATERIAL |
| N/A | 1 | SK9-001B | SLS1 MOUNT | N/A |
| 1 | 3 | N/A | CAPTIVE SCREW Z12-6-H(BERG) | STAINLESS |
| 2 | 2 | N/A | DOWEL PIN 1/8 x 1/2 D14-10(BERG) | STAINLESS |
| 3 | 3 | SK5-026A | GRATING CLIP | PHOS.BRONZE |
| 4 | 3 | N/A | HEX SOCKET HEAD 2-56 x 3/16 | STAINLESS |
| 5 | 4 | N/A | HEX SOCKET HEAD 4-40 x 3/8 | STAINLESS |
| 6 | 1 | SK9-012A | SLS1 AXIAL SUPPORT/MASK | ALU 6061-T6 |
| 7 | 1 | SK9-011A | SLS1 FRONT BAFFLE | ALU 6061-T6 |
| 8 | 1 | SK9-013B | SLS1 GRATING MOUNT | ALU 6061-T6 |
| 9 | 1 | SK9-014B | SLS1 GRATING | GLASS |
| 10 | 2 | SK5-015A | SXD1 GRATING SPRING RADIAL | PHOS.BRONZE |

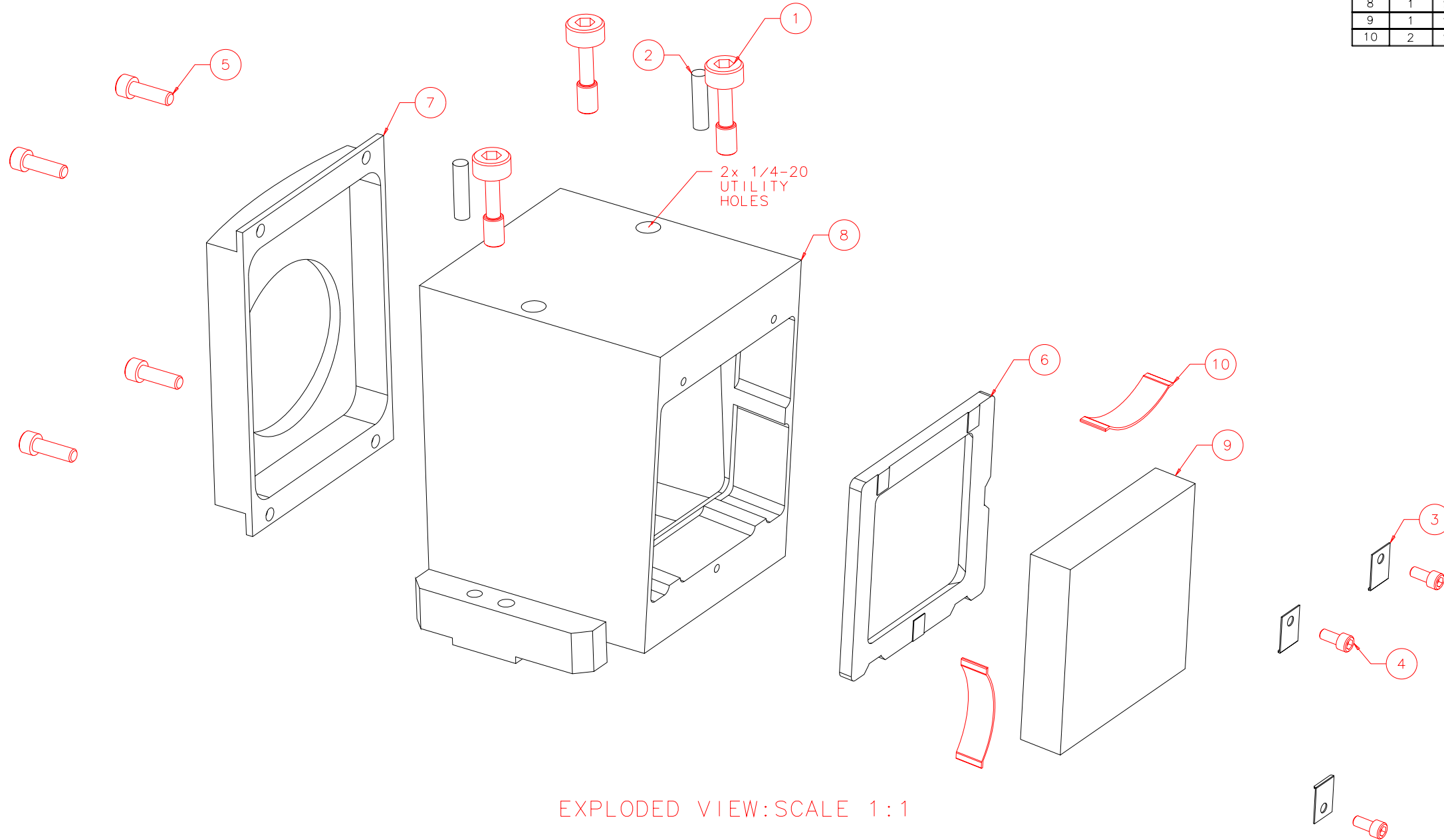

EXPLODED VIEW: SCALE 1:1

| | |
|---------------------|---|
| REVDATE: N/A | REVISION: N/A |
| DATE: 08/24/99 | INSTITUTE FOR ASTRONOMY |
| DESIGN: STAHLBERGER | 2680 WOODLAWN DR. HONOLULU, HI 96822 |
| DRAWN: STAHLBERGER | INSTRUMENT: SPEX - CROSS DISPERSED SPECTROGRAPH |
| APPR'D: J. RAYNER | PART NAME: SLS1 MOUNT |
| TOLERANCES | TELESCOPE: IRTF |
| X.X +/- .015 | |
| X.XX +/- .005 | |
| X.XXX +/- .002 | |
| ANGLE +/- 30 min | |
| FRACTION +/- 1/32 | |
| SK0-001B | DRW NO: SK9-001B |
| NEXT ASSY | SCALE: 1:1 |
| | SIZE: B |
| | JOS NO: 725 |
| | SHEET: 1 OF 1 |

PLOT: 10/19/99