

NOTES: UNLESS OTHERWISE NOTED  
 1. MACHINED SURFACE ROUGHNESS 64  
 O-RING GROOVES AND SURFACES 32  
 2. REMOVE ALL BURRS/SHARP CORNERS

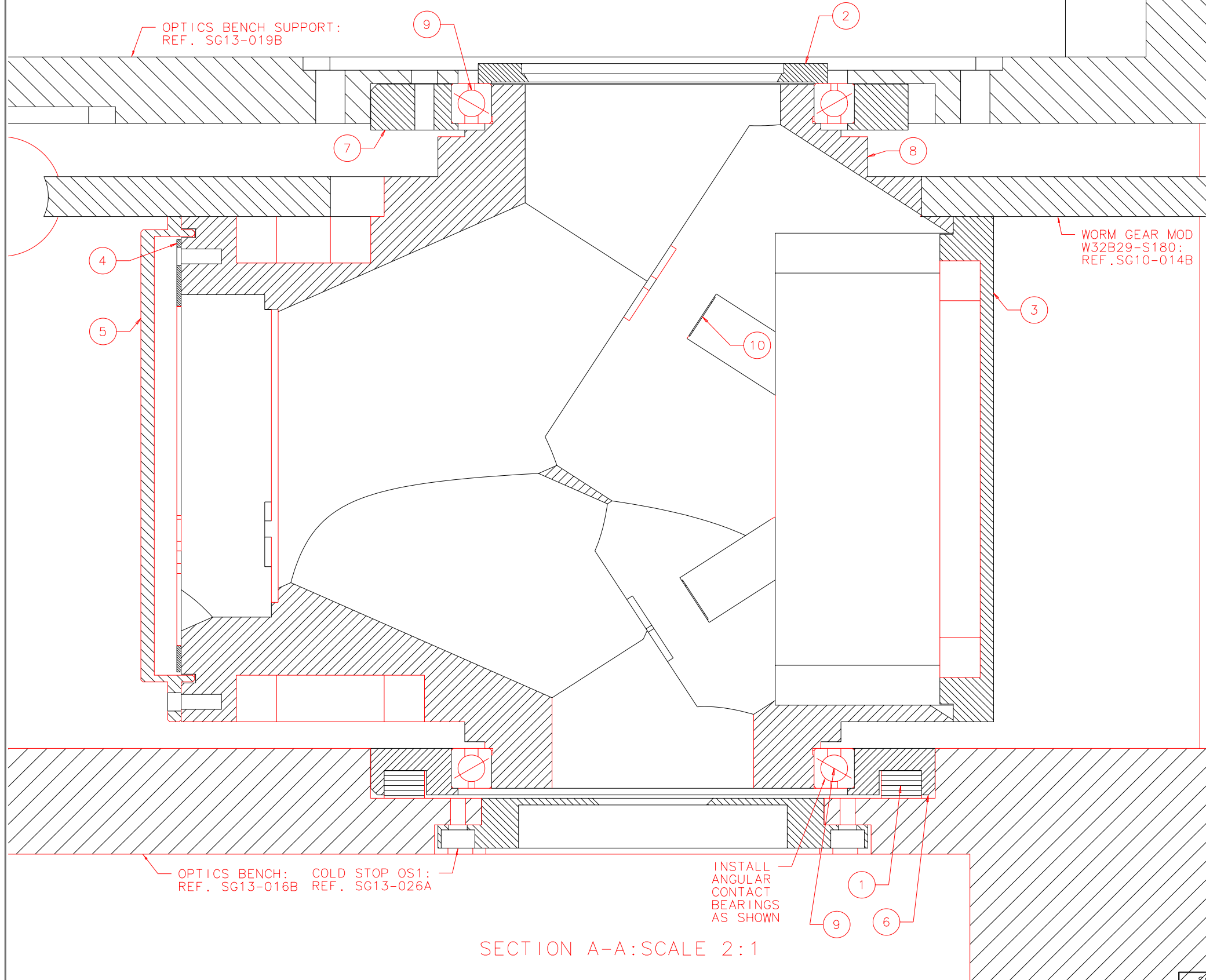

BILL OF MATERIAL				
NO.	REQ'D	REF DRW	DESCRIPTION	MATERIAL
N/A	1	SG11-001B	K-MIRROR MOUNT	N/A
1	1	N/A	SPRING SSR-0250S17(SMALLEY)	STAINLESS
2	1	SG11-011A	BEARING RETAINER	ALU 6061-T6
3	1	SG11-013A	COVER	ALU 6061-T6
4	1	SG11-014A	FLAT4 AXIAL SPRING	PHOS.BRONZE
5	1	SG11-015A	FLAT4 COVER	ALU 6061-T6
6	1	SG11-016A	HOOP RING1	STAINLESS 303
7	1	SG11-017A	HOOP RING2	STAINLESS 303
8	1	SG11-018B	K-MIRROR SUPPORT	ALU 6061-T6
9	2	N/A	KAYDON BEARING KAA15AGO	STAINLESS
10	6	SG11-019A	MIRROR CLIP	PHOS.BRONZE

NOTES:  
 A) USE VENTED SCREWS FOR NONPENETRATING TAPPED HOLES

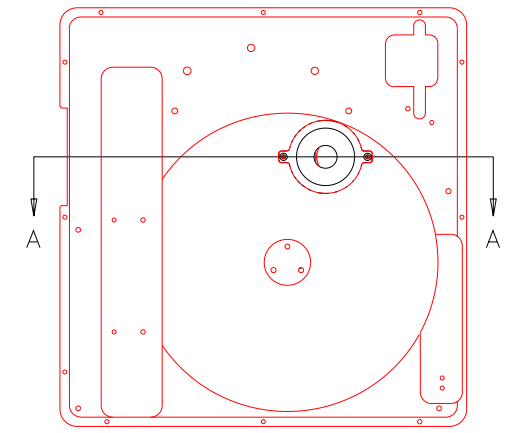

FRONT: SCALE 1:4

REVDATE: 01/12/99	REVISION: ADD MIRROR CLIP 10
REVDATE: N/A	REVISION: N/A
DATE: 05/28/98	<b>INSTITUTE FOR ASTRONOMY</b>
DESIGN: STAHLBERGER	2680 WOODLAWN DR. HONOLULU, HI 96822
DRAWN: STAHLBERGER	INSTRUMENT: SPEX - CROSS DISPERSED SPECTROGRAPH
APPR'D: J. RAYNER	PART NAME: K-MIRROR MOUNT
<b>TOLERANCES</b>	
X.X	+/- .015
X.XX	+/- .005
X.XXX	+/- .002
ANGLE	+/- 30 min
FRACTION	+/- 1/32
DRW NO: SG11-001B	SCALE: 2:1
SIZE: B	JOS NO: 725
	SHEET: 1 OF 1