

NOTES: UNLESS OTHERWISE NOTED

1. MACHINED SURFACE ROUGHNESS 64
O-RING GROOVES AND SURFACES 32
2. REMOVE ALL BURRS/SHARP CORNERS

BILL OF MATERIAL				
NO.	REQ'D	REF DRW	DESCRIPTION	MATERIAL
N/A	1	SG13-024A	SPACER	ALU 6061-T6



LEFT

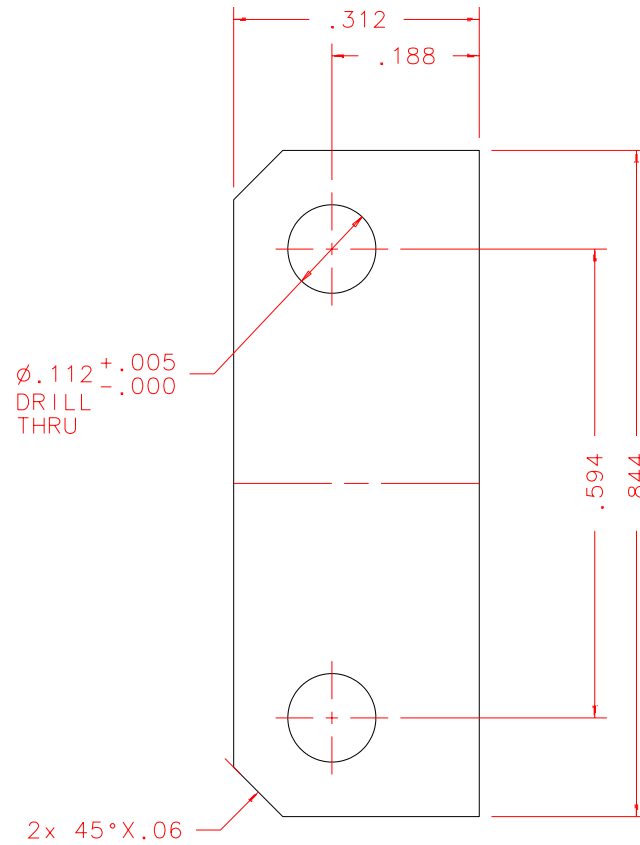

FRONT

REVDATE: N/A	REVISION: N/A	
DATE: 05/09/98	INSTITUTE FOR ASTRONOMY 2680 WOODLAWN DR. HONOLULU, HI 96822	
DESIGN: STAHLBERGER		
DRAWN: STAHLBERGER	INSTRUMENT: SPEX - CROSS DISPERSED SPECTROGRAPH	
APPR'D: J. RAYNER	PART NAME: SPACER	
TOLERANCES		
X.X	+/- .015	
X.XX	+/- .005	
X.XXX	+/- .002	
ANGLE	+/- 30 min	
FRACTION	+/- 1/32	
TELESCOPE: IRTF		
SG13-001B	DRW NO: SG13-024A	SCALE: 4:1
NEXT ASSY	SIZE: A	JOS NO: 725
		SHEET: 1 OF 1

PLOT:10/19/99