

NOTES: UNLESS OTHERWISE NOTED
 1. MACHINED SURFACE ROUGHNESS 64
 O-RING GROOVES AND SURFACES 32
 2. REMOVE ALL BURRS/SHARP CORNERS

BILL OF MATERIAL				
NO.	REQ'D	REF DRW	DESCRIPTION	MATERIAL
N/A	1	SN2-001B	COLD BUS BAR	N/A
1	3	SN2-011A	BUS BAR SUPPORT	G-10
2	1	SN2-012B	BUS SHIELD	ALU 6061-T6
3	1	SN2-013B	COLD BAR	COPPER OFHC
4	1	SN1-014A	INSULATION DISK	G-10
5	1	SN1-015A	INSULATION RETAINER	ALU 6061-T6
6	6	SN2-014A	SUPPORT SPACER	ALU 6061-T6
7	1	SD4-025B	TRIPLE JUNCTION	COPPER OFHC
8	1	SD4-026A	TRIPLE JUNCTION INSULATOR	G-10
9	2	SD4-027A	TRIPLE JUNCTION SPACER	ALU 6061-T6
10	4	SN2-015A	WASHER	G-10

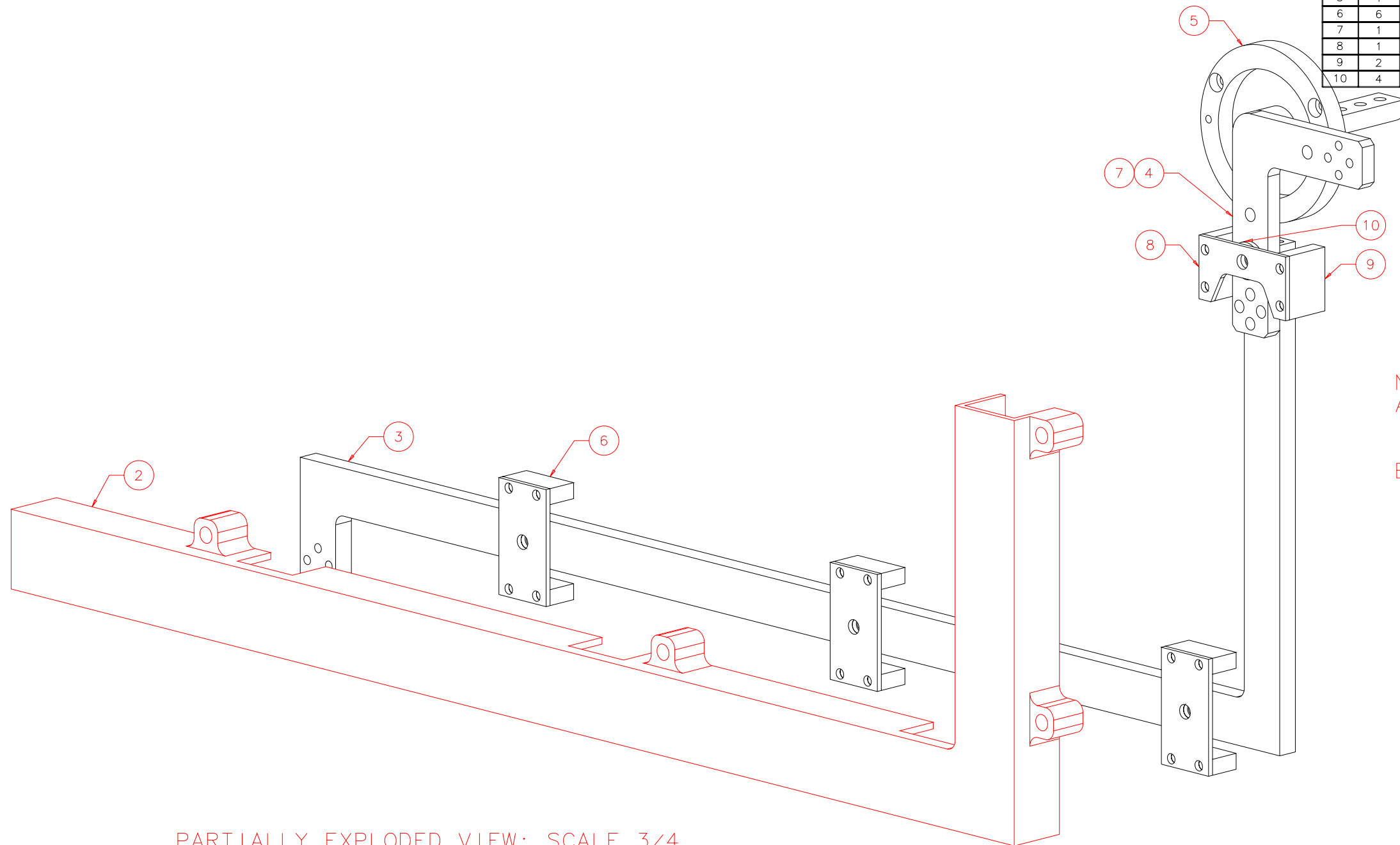

NOTES:
 A) USE VENTED SCREWS FOR ALL NONPENETRATING TAPPED HOLES.
 B) USE THIS ASSEMBLY IN CONJUNCTION WITH ASSEMBLY SD4-001B

PARTIALLY EXPLODED VIEW: SCALE 3/4

REVDATE: 04/14/99	REVISION: DESIGN CHANGE UPDATE
REVDATE: 05/08/98	REVISION: ADD PART SN1-015A
REVDATE: N/A	REVISION: N/A
DATE: 01/28/98	INSTITUTE FOR ASTRONOMY
DESIGN: STAHLBERGER	2680 WOODLAWN DR. HONOLULU, HI 96822
DRAWN: STAHLBERGER	INSTRUMENT: SPEX - CROSS DISPERSED SPECTROGRAPH
APPR'D: J. RAYNER	PART NAME: COLD BUS BAR
TOLERANCES	TELESCOPE: IRTF
X.X	+/- .015
X.XX	+/- .005
X.XXX	+/- .002
ANGLE	+/- 30 min
FRACTION	+/- 1/32
SNO-001B	DRW NO: SN2-001B
NEXT ASSY	SCALE: 1:1
	SIZE: B
	JOS NO: 725
	SHEET: 1 OF 1

PLOT: 10/19/99