

NOTES: UNLESS OTHERWISE NOTED

1. MACHINED SURFACE ROUGHNESS 64  
O-RING GROOVES AND SURFACES 32
2. REMOVE ALL BURRS/SHARP CORNERS

BILL OF MATERIAL				
NO.	REQ'D	REF DRW	DESCRIPTION	MATERIAL
N/A	1	SO1-019A	LID IMAGE BOX -X	ALU 6061-T6

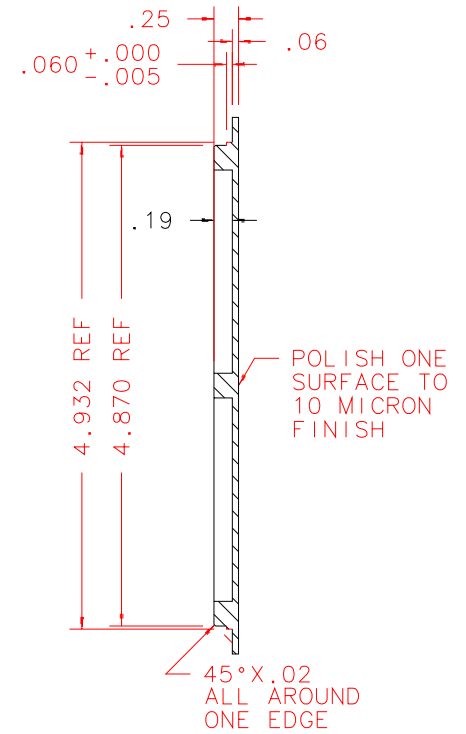
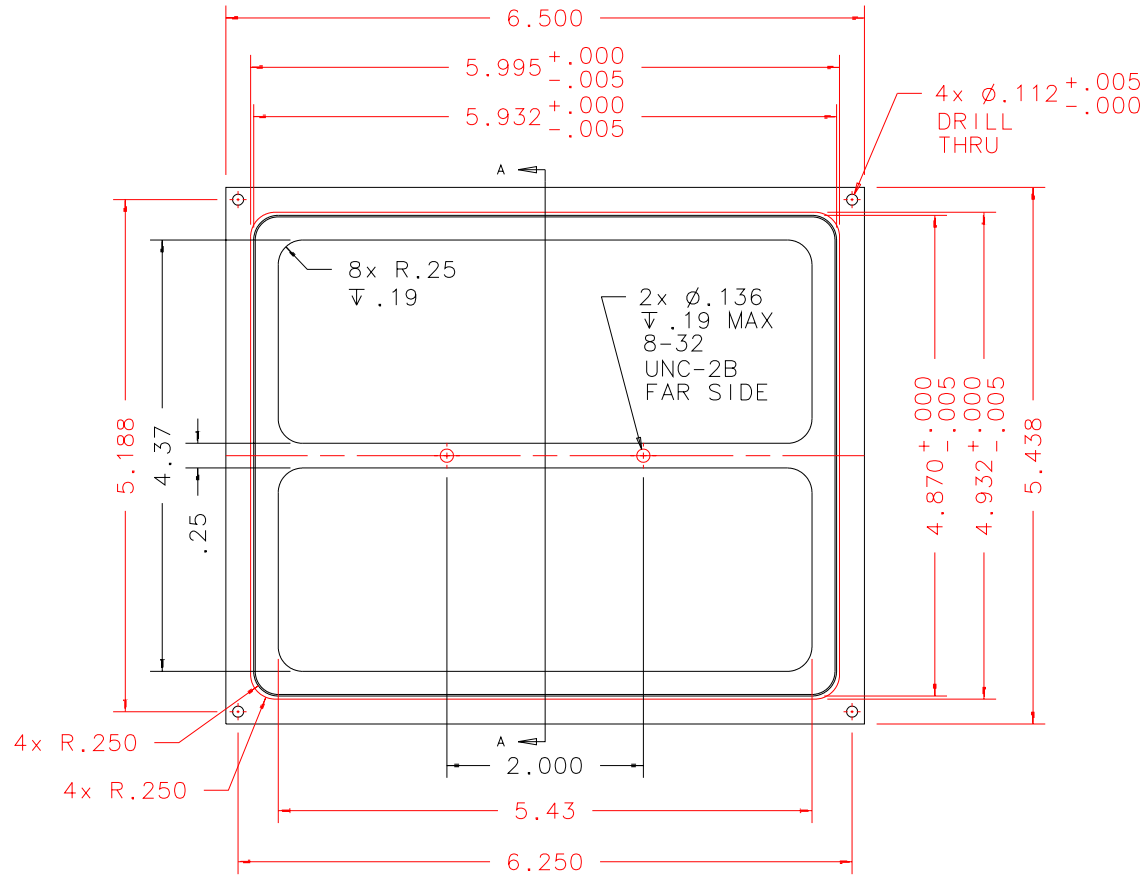

SECTION A-A

FRONT

REVDATE: 02/05/99	REVISION: ADD 2 POCKET, 2 TAPPEN HLS
REVDATE: N/A	REVISION: N/A
DATE: 06/12/98	<b>INSTITUTE FOR ASTRONOMY</b>
DESIGN: STAHLBERGER	2680 WOODLAWN DR. HONOLULU, HI 96822
DRAWN: STAHLBERGER	INSTRUMENT: SPEX - CROSS DISPERSED SPECTROGRAPH
APPR'D: J. RAYNER	PART NAME: LID IMAGE BOX -X
	TELESCOPE: IRTF
	DRW NO: SO1-019A
	SCALE: 1:2
	SIZE: A
	JOS NO: 725
	SHEET: 1 OF 1

SO1-001B
NEXT ASSY

PLOT: 10/19/99