

NOTES: UNLESS OTHERWISE NOTED

1. MACHINED SURFACE ROUGHNESS 64
O-RING GROOVES AND SURFACES 32
2. REMOVE ALL BURRS/SHARP CORNERS

NOTE: ASSEMBLY VIEWER TRIPLET1 S02-001A
AND VIEWER TRIPLET2 S03-001A
HAVE COMMON PARTS
BUNDLE TOGETHER WHEN
FABRICATING

BILL OF MATERIAL				
NO.	REQ'D	REF DRW	DESCRIPTION	MATERIAL
N/A	1	S02-001A	VIEWER TRIPLET 1	N/A
1	1	S02-011A	AXIAL SPRING	PHOS.BRONZE
2	1	S02-012A	AXIAL SPRING SPACER	ALU 6061-T6
3	1	S02-026A	BAFFLE TUBE2	ALU 6061-T6
4	1	S02-027A	LENSMOUNT BAFFLE 1	ALU 6061-T6
5	1	S02-019A	RADIAL SPRING	PHOS.BRONZE
6	1	S02-011A	LENS 4	BAF2
7	1	S02-012A	LENS 5	LIF
8	1	S02-013A	LENS 6	ZNS
9	1	S02-014A	LENS SPACER 1	ALU 6061-T6
10	1	S02-015A	LENS SPACER 2	ALU 6061-T6
11	2	S02-020A	TUBE CLIP	PHOS.BRONZE
12	1	S02-021A	TUBE1	ALU 6061-T6
13	1	S02-022A	TUBE2	ALU 6061-T6
14	1	S02-025B	VIEWER TRIPLET LENS MOUNT	ALU 6061-T6

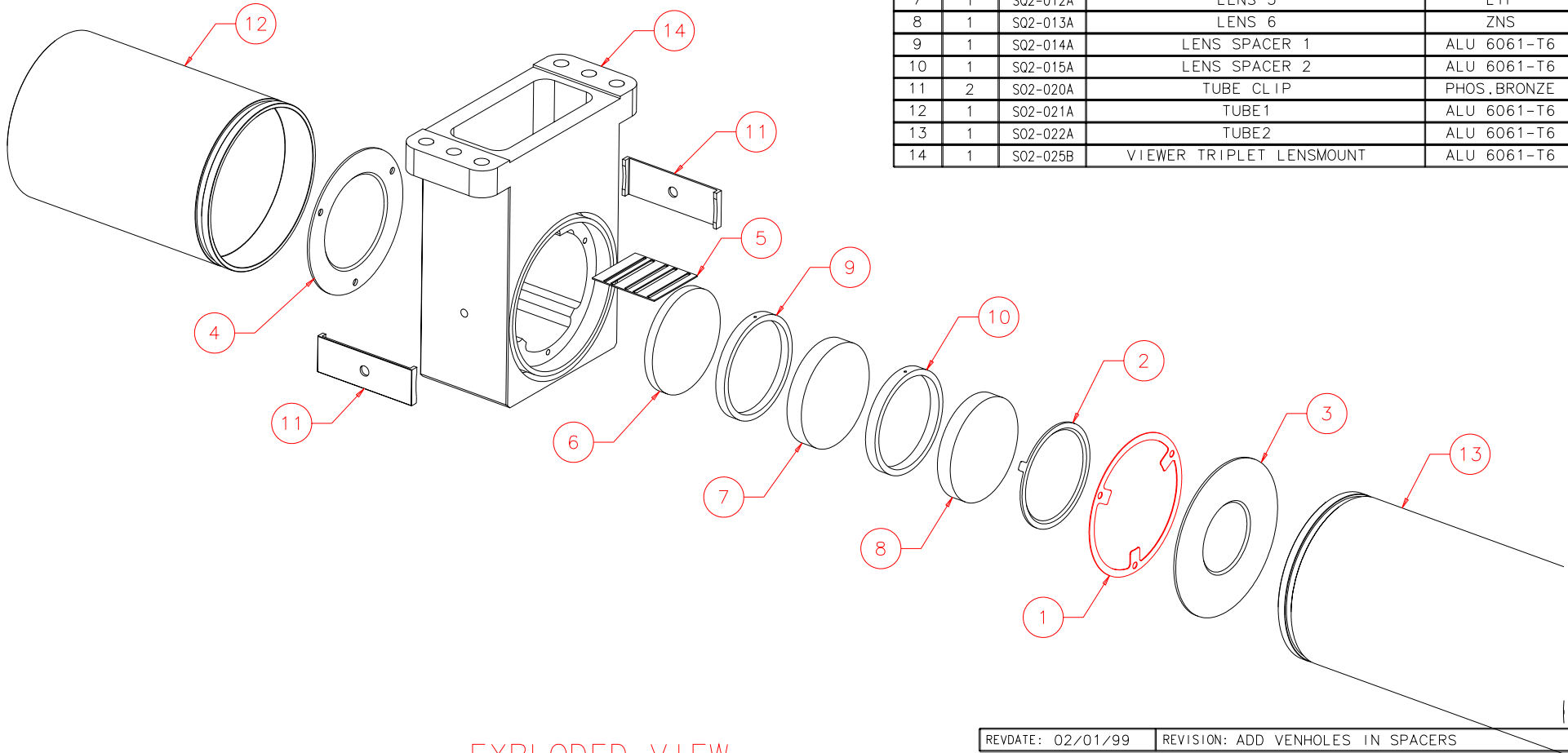

EXPLODED VIEW
SCALE 1:2

REVDATE: 02/01/99	REVISION: ADD VENHOLES IN SPACERS
REVDATE: N/A	REVISION: N/A
DATE: 11/04/98	INSTITUTE FOR ASTRONOMY 2680 WOODLAWN DR. HONOLULU, HI 96822
DESIGN: STAHLBERGER	
DRAWN: STAHLBERGER	INSTRUMENT: SPEX - CROSS DISPERSED SPECTROGRAPH
APPR'D: J. RAYNER	PART NAME: VIEWER TRIPLET 1
TOLERANCES	
X.X	+/- .015
X.XX	+/- .005
X.XXX	+/- .002
ANGLE	+/- 30 min
FRACTION	+/- 1/32
DRW NO: S02-001A	SCALE: NOTED
SIZE: A	JOS NO: 725
SHEET: 1 OF 2	

PLOT:10/19/99

S00-001B
NEXT ASSY