

BILL OF MATERIAL				
ITEM	QTY.	DESCRIPTION	MATERIAL	NOTE
1	1	400.0 x 350.0 x 6.35 Plate	ALUM 6061	

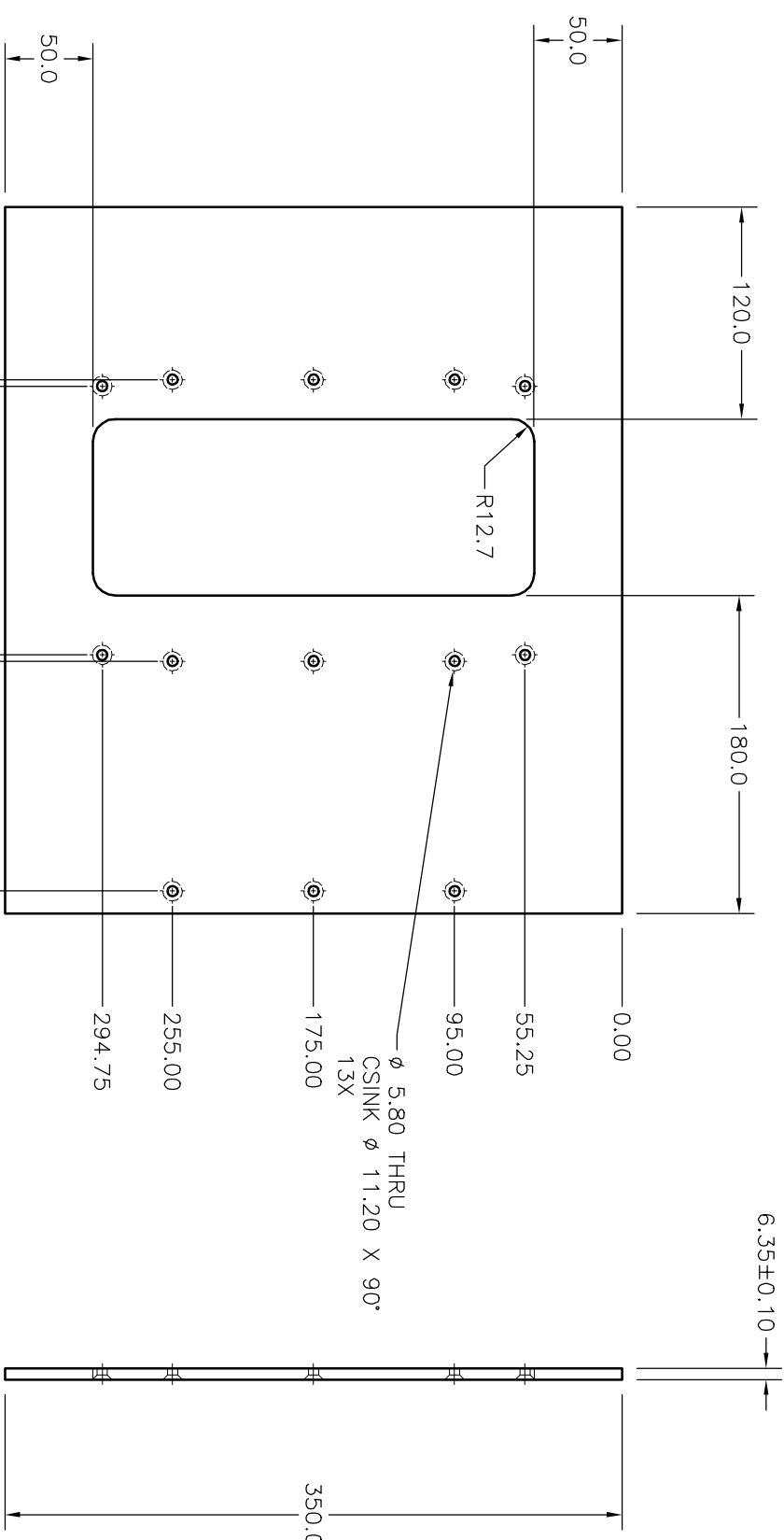
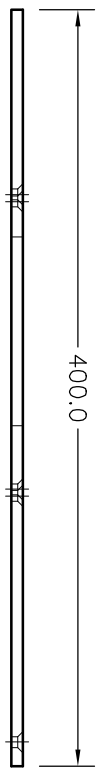

NOTES:
 1 REMOVE ALL BURRS AND SHARP EDGES

UNLESS OTHERWISE STATED
 ALL DIMENSIONS IN MILLIMETERS

TOLERANCES
 X ± 0.500
 X.X ± 0.100
 X.XX ± 0.050
 X.XXX ± 0.010
 ANGLE ± 0.30°

MACHINING FINISH
 N7 - 1.8µm - 6.3µm

EDGE BREAK
 0.3mm x 45°

PROJECT
 NASA INFRARED TELESCOPE FACILITY
 Institute for Astronomy
 University of Hawaii
 2680 Woodlawn Drive
 Honolulu, HI, 96822

REV	LOC	DESCRIPTION	BY	DATE	DESIGNED TB	DRAWN TB	CHECKED TB	SCALE	DWG. No.	REV
1		REVIEWED & ISSUED	TB	Dec 11/03				1:4	2003	1.0
REVISION										

